

SERRACAVI

CABLE CLAMPS



Tipo 1 Type 1



Tipo 2 Type 2

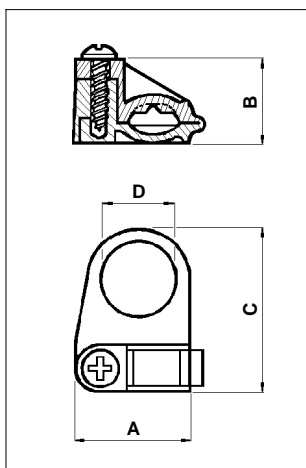
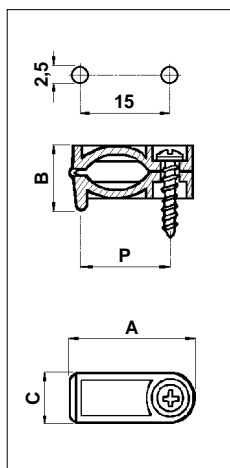

- **MATERIALE = PA 6.6**
MATERIAL = PA 6.6
- **AUTOESTINGUENZA = V2 (UL94)**
UL FLAMMABILITY = V2 (UL94)
- **COLORE = Naturale**
COLOUR = Natural

NOTA Dc = Diametro massimo del cavo.

NOTE Dc = Max. cable diameter.

CODICE P/N	Tipo Type	DIMENSIONI SIZES					Dc	NOTE NOTES	CONF. PKG. pz. pcs.
		A	B	C	D	P			
3284 AA01 FS	1	20	9,5	8		15	6	1.000	
3285 AA01 FS	2	22	14	28,5	4		3,9x6,4	1.000	

Tutte le quote sono in mm. / All the dimensions are in mm.