

Rocker Switch

RK2-13

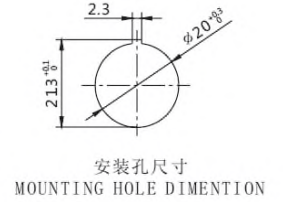

ON-OFF (1×1)		2P
ON-ON (1×2)		3P
ON-OFF-ON (1×3)		3P
ON-OFF (1×1N)		3P

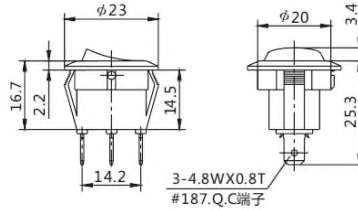

RK2-13C



ON-OFF (1×1)		2P
ON-ON (1×2)		3P
ON-OFF (1×1N)		3P

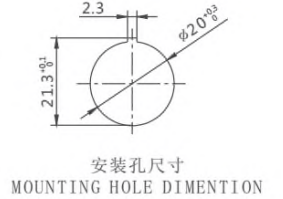
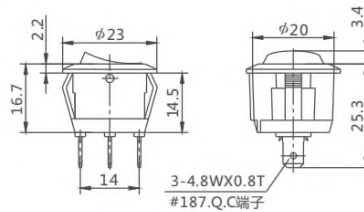

RK2-13D



ON-OFF (2×1)		4P
ON-OFF (2×1N)		4P

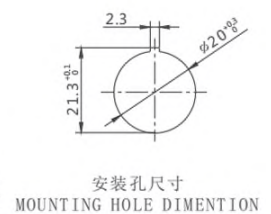
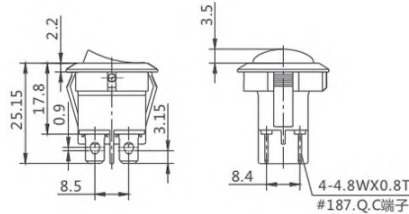

电气参数 Electrical Data

- 1、接触电阻 Contact Resistance: 100mΩMax
- 2、绝缘电阻 Insulation Resistance: 500VDC, 100MΩMin
- 3、耐压强度 Dielectric Strength:
端子间 Terminal and terminal: 1500VAC 5s
端子与接地间 Terminal and ground: 3000VAC 5s
- 4、工作温度 Operating Temperature: -25℃ ~ 85℃
- 5、电气寿命 Electrical Life: 10000 Cycles

6、额定值 Rating:

RK2系列 Series: 6A 125VAC, 10A 125/250VAC(UL)
6(4)A 250VAC(VDE)
10A 250VAC(TUV KEMA/ENEC CQC)
16A 250VAC T100/55(CQC TUV)



Rocker Switch

RK2-11

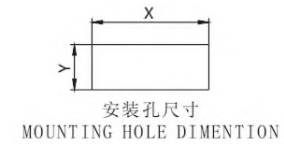
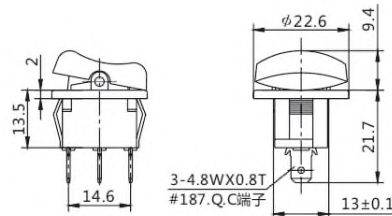

t	X	Y
0.75-1.25	19.0 ^{+0.1}	13.1 ^{+0.1}
1.25-2.00	19.1 ^{+0.1}	13.1 ^{+0.1}
2.00-3.00	19.2 ^{+0.1}	13.1 ^{+0.1}

t为材料厚度
Panel Thickness

ON-OFF (1×1)		2P
ON-ON (1×2)		3P
ON-OFF-ON (1×3)		3P

RK2-37

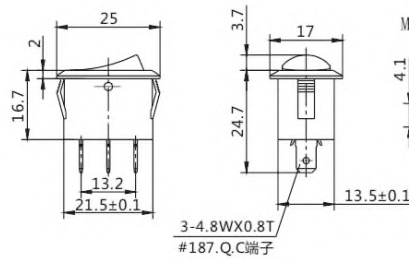

t	X	Y
0.75-1.25	21.7 ^{+0.1}	13.6 ^{+0.1}
1.25-2.00	22.4 ^{+0.1}	13.6 ^{+0.1}

安装面板厚度<2mm
Panel Thickness<2mm

ON-OFF (1×1)		2P
ON-ON (1×2)		3P
ON-OFF (1×1N)(常通)		3P

RK1-05

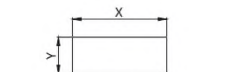
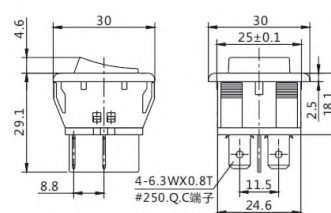

t	X	Y
0.75-1.25	25.4 ^{+0.1}	25.1 ^{+0.1}
1.25-2.00	25.5 ^{+0.1}	25.1 ^{+0.1}
2.00-3.00	25.6 ^{+0.1}	25.1 ^{+0.1}

t为材料厚度
Panel Thickness

ON-OFF (2×1)		4P
ON-OFF (2×1N)		4P
ON-ON (2×2)		6P

电气参数 Electrical Data

- 1、接触电阻 Contact Resistance: 100mΩMax
- 2、绝缘电阻 Insulation Resistance: 500VDC, 100MΩMin
- 3、耐压强度 Dielectric Strength:
端子间 Terminal and terminal: 1500VAC 5s
端子与接地间 Terminal and ground: 3000VAC 5s
- 4、工作温度 Operating Temperature: -25℃~85℃
- 5、电气寿命 Electrical Life: 10000 Cycles

6、额定值 Rating:

RK2系列 Series: 6A 125VAC, 10A 125/250VAC(UL)
6(4)A 250VAC(VDE)
10A 250VAC(TUV KEMA/ENEC CQC)
16A 250VAC T100/55(CQC TUV)

